



CONFERENCE SCHEDULE

ANTHROPÔLE BUILDING FLOOR PLAN

FOURTH FLOOR

ROOM 4144:
Alternative conference space*

SECOND FLOOR

AMPHI 2024

Main entrance/
Metro exit

WC Restroom

◄ Lift

◄◄ Metro exit

◄ Stairs going up

◄ Stairs going down

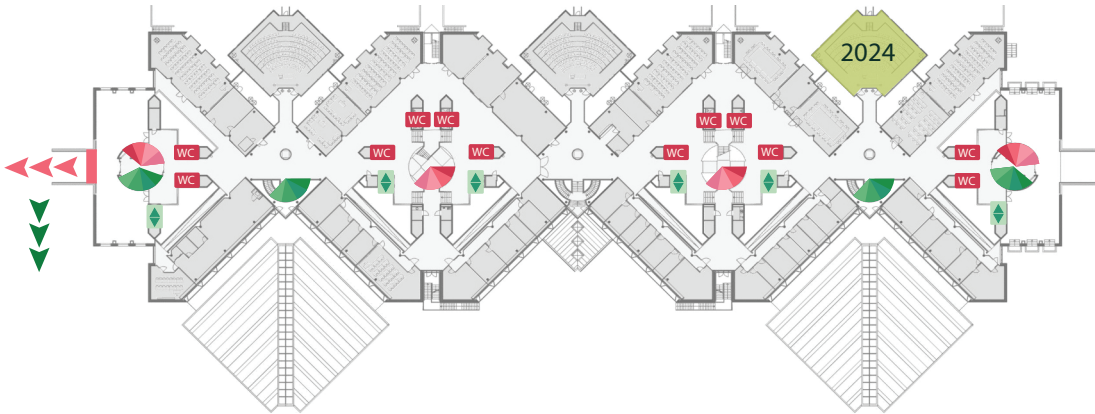

FIRST FLOOR

AMPHI 1029

AMPHI 1031

AMPHI 1058: Infirmary**

Poster area

Coffee area

Registration desk

WC Restroom

◄ Lift

◄◄ Darwin dinner exit

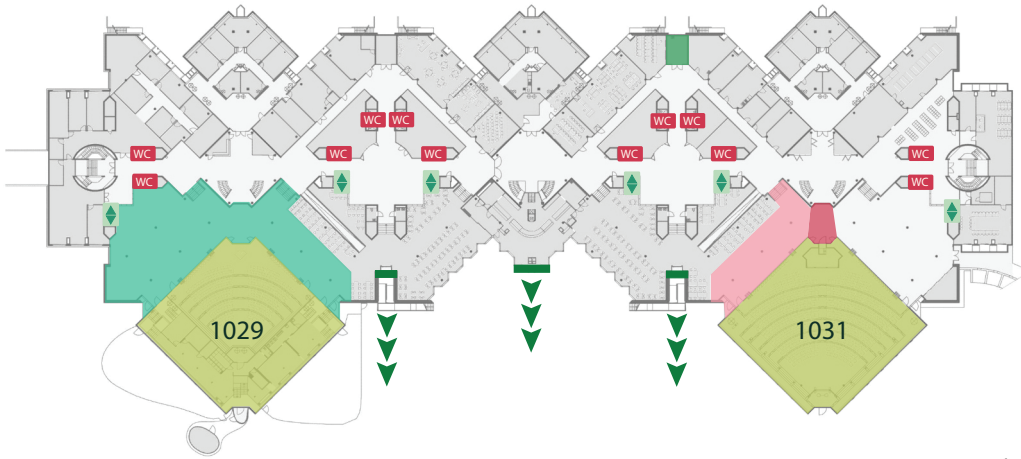

*Extra space for e.g. emergency childcare while streaming talks

**for e.g. chestfeeding, please request access card from registration desk

CAMPUS MAP

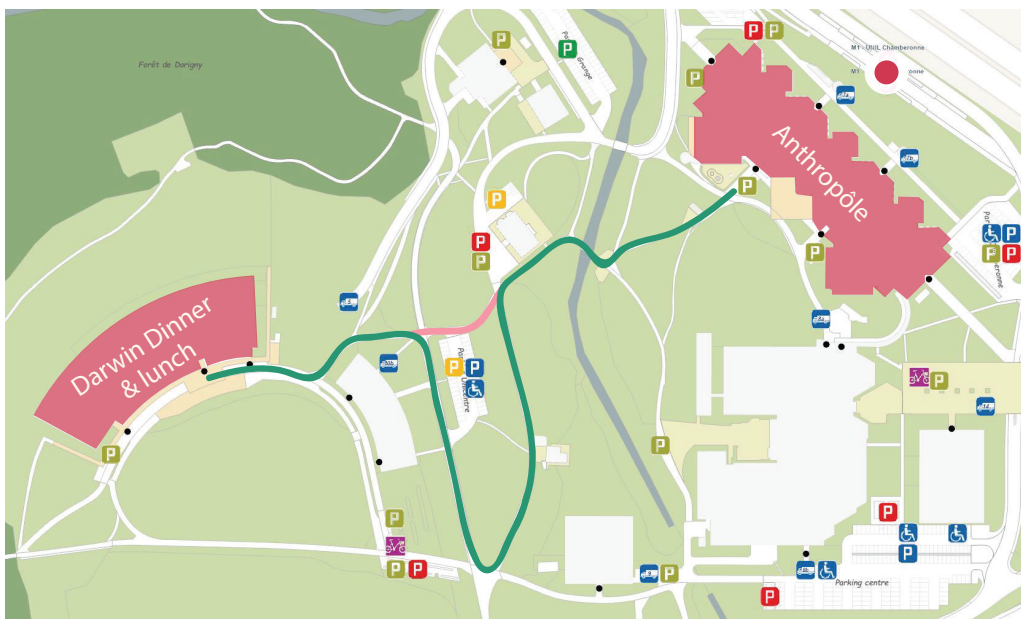

● Metro stop UNIL

Chamberone

— Wheelchair accessible path

— Walking path



WEDNESDAY FEBRUARY 12

SATELLITE EVENTS

SELFISH GENETIC ELEMENTS & WITHIN-ORGANISM CONFLICTS

09:00 - 19:00

ANTHROPÔLE ROOM 2106

- 09:00 - 09:30 Registration (main conference registraton desk)
- 09:30 - 10:20 Talk 1: Daven Presgraves
- 10:30 - 11:20 Talk 2: Marie Delattre
- 11:30 - 12:20 Talk 3: Anna Lindholm
- 12:30 - 13:30 Lunch (same place as for main conference)
- 13:40 - 14:30 Talk 4: Ellen Clarke (online)
- 14:40 - 15:30 Talk 5: Andy Gardner
- 15:40 - 16:00 Coffee break (same place as for main conference)
- 16:00 - 15:50 Talk 6: Tatiana Dimitriu
- 17:00 - 17:50 Talk 7: Rafael Pinilla-Redondo
- 18:00 - 18:15 Closing remarks
- 18:15 - 19:00 Social gathering (coffee area of main conference)

SDM-CH: MODELING SPECIES DISTRIBUTIONS IN SWITZERLAND

12:30 - 19:00

ANTHROPÔLE ROOM 2024

- 12:30 - 13:00 Registration (main conference registraton desk)
- 13:00 - 14:30 Introduction, 15m talks & discussion *Damaris Zurell, Antoine Adde, Ramona Maggini, Nathan Külling, Lukas Mathys*
- 14:30 - 14:50 Coffee break (same place as for main conference)
- 14:50 - 16:05 15m talks and discussion *Blaise Petitpierre, Nicolas Strebelt, Sibylle Stöckli, Luca Butiköfer, Caröline Martin*
- 16:05 - 16:25 Coffee break (same place as for main conference)
- 16:25 - 18:00 15m talks, discussion & round table *Niklaus Zimmermann, Sergio Vignali, Christopher Johnson*
- 18:00 - 19:00 Social gathering (coffee area of main conference)

HARNESSING SINGLE-CELL OMICS IN EVOLUTIONARY BIOLOGY

14:00 - 19:00

ANTHROPÔLE ROOM 3185

- 14:00 - 14:30 Registration (main conference registraton desk)
- 14:30 - 16:00 Talk by invited speaker and discussion
- 16:00 - 16:30 Coffee break (same place as for main conference)
- 16:30 - 18:00 Discussion
- 18:00 - 19:00 Social gathering (coffee area of main conference)

THURSDAY FEBRUARY 13

Registration

08:00 - 09:00

PLENARY 1

09:00 - 10:00

SUSANNA COELHO
ANTHROPÔLE 1031

Coffee break

10:00 - 10:30

SEE MAP FOR LOCATION

PARALLEL SESSIONS

10:30 - 12:00

SESSION 1: ADAPTATION & SELECTION (Chair Thibault Latrille)

ANTHROPÔLE 1031

Fast-paced evolution of commensal bacteria facilitates insect host development under chemical stress
(Henry Youn)

Unveiling phenotypic evolution: stickleback adaptation of foraging traits after release from intraguild predators
(Zixin Li)

Estimates of molecular convergence reveal pleiotropic genes underlying adaptive variation across teleost fish
(Agneesh Barua)

Edaphic adaptation in the alpine carnation *Dianthus sylvestris*
(Veronika Lipánová)

Climate drives variation in gene expression patterns for a lichen's fungal and algal symbionts
(Henrique de Aguiar Valim)

Evolutionary conservation and temporal constraints of moulting gene expression in Pancrustacea
(Kenneth Kim)

SESSION 2: SEX & REPRODUCTION (Chair Luca Soldini)

ANTHROPÔLE 1029

Life-history trade-off and genetic variance of sex allocation traits under diversifying selection
(Ehouarn Le Faou)

Disruptive selection on sex allocation explains dioecy in a wind-pollinated herb
(Kai-hsiu Chen)

Secondary recombination in non-recombining regions revealed by sex chromosome analysis of blackspotted stickleback (*Gasterosteus wheatlandi*)
(Zuyao Liu)

Gene-by-gene evolution of dosage compensation in a neo-XY sex chromosome system
(Vincent Mérel)

An explanation for the prevalence of XY over ZW sex determination in species derived from hermaphroditism
(Thomas Lesaffre)

The function of male exaggerated weaponry in tree lobster stick insects
(Romain Boisseau)

SESSION 3: POPULATION & HABITAT CONSERVATION (Chair Caleb Beck)

ANTHROPÔLE 2024

Unraveling the effects of annual temperature variability on turtle population dynamics
(Shaquille Matthys)

Family size and age structure of the Eurasian Beaver *Castor fiber* under density dependence
(Nicolas Stettler)

Metapopulations in the Anhtopocene
(Maja Bosjakovic)

Restoring plant diversity in lowland grasslands: efficacy of different seed addition methods
(Laura Forgione)

Towards real-time conservation by accounting for AI classification errors
(Aimée Freiberg)

Hierarchical species distribution models for invasive species
(Bart Steen)

Lunch

12:00 - 13:30

SEE MAP FOR LOCATION

ZOOLOGY PRIZE & PRIZE TALK
ANTHROPÔLE 1031

13:30 - 14:00

PLENARY 2
INGER ALSOS
ANTHROPÔLE 1031

14:00 - 15:00

Coffee break
SEE MAP FOR LOCATION

15:00 - 15:30

PARALLEL SESSIONS
SESSION 4: ENVIRONMENT & COMMUNITIES (Chair Pooja Nautiyal)
ANTHROPÔLE 1031

15:30 - 17:00

Paddy rice: a win-win for biodiversity and agriculture
(Thea Bulas)

Responses of terrestrial insect species to climate and land use change across Switzerland
(Benjamin Walter)

The rainbow connection: the case for including substrate colour in the 'eco-engineering' of marine constructions
(Holly Cunningham)

Kick-net vs. eDNA: year round methodological comparison of benthic macroinvertebrate community in an alpine river
(Eduard Mas i Carrió)

Migration's double-edged sword: benefits and risks in changing seasonal metaecosystems
(Lara Chaouat)

Community diversity of Swiss diatoms assessed through metabarcoding
(Elia Rossini)

SESSION 5: PHENOTYPE & TRAIT VARIATION (Chair Diego Hartasanchez Frenk)
ANTHROPÔLE 1029

Phenotypic responses to whole-genome duplication vs post-polyploidy evolution in *Biscutella laevigata*
(Sandra Grünig)

Water deficit effects on the sRNA qualitative and quantitative profiles of an in vitro carrot colonized by the arbuscular mycorrhizal fungus *Rhizophagus irregularis* (Brenda Rios Ochoa)

Adaptive landscapes across multiple scales
(Malvika Srivastava)

Phenotypic integration may constrain trait adaptation in an annual plant
(Shengman Lyu)

Genomic insights into arthropod moulting: evolutionary dynamics of conserved developmental pathways across arthropod diversity (Giulia Campi)

Interactive effects of heat waves and drought on grassland plants across seasons
(Nicolò Tartini)

SESSION 6: BIOGEOGRAPHY & MACROECOLOGY (Chair Luca Butikofer)
ANTHROPÔLE 2024

The increasing frequency of secondary spread over time accelerates insect invasions
(Aymeric Bonnamour)

Latitudinal constraints on climatic-niche evolution of vertebrates at the macro-evolutionary scale
(Théo Gaboriau)

Global distribution of sociality and its associations with environmental conditions in ants
(Eddie Pérochon)

Shades of diversity: exploring ant colouration across latitudes and environments
(Tristan Klafitenberger)

Massive undiscovered species richness in Afrotropical Darwin wasps (Ichneumonidae, Hymenoptera)
(Noah Meier)

Navigating socio-ecological dynamics: predicting and managing human-wolf conflict in Switzerland
(Carolyn Schaltegger)

POSTER SESSION A & APERO
APER0 IN POSTER AREA, SEE MAP

17:00 - 18:00

DARWIN LECTURE & DINNER
CATHERINE PEICHEL
SEE MAP FOR LOCATION

18:30 - 00:00



FRIDAY FEBRUARY 14

Late registration

08:00 - 09:00

PLENARY 3

09:00 - 10:00

ANDREANNA WELCH

ANTHROPÔLE 1031

Coffee break

10:00 - 10:30

SEE MAP FOR LOCATION

PARALLEL SESSIONS

10:30 - 12:00

SESSION 7: BEHAVIOURAL ECOLOGY (Chair Marina Choppin)

ANTHROPÔLE 1031

Adaptive social flexibility in cooperative breeders: correlations between helping and social competence in *Neolamprologus pulcher* (Océane Ferreira)

A unified evolutionary framework for understanding parasite infection and host migratory behaviour (Sandra Binning)

Movement patterns and magnetic orientation in a glassfrog with parental care (Marina Garrido-Priego)

Socially-mediated dispersal favors the evolution of cooperators and defectors (Iris Prigent)

Socially responsive crickets: insights into the evolutionary consequences of behavioural interactions (Tom Ratz)

Effects of temperature and snow on the reproductive performance of a climate-sensitive bird species (Carole Niffenegger)

SESSION 8: POPULATION GENETICS & PHYLOGENETICS (Chair Alexandros Topaloudis)

ANTHROPÔLE 1029

Inbreeding depression in wild barn owls: effect on growth rates and underlying genetic architecture (Anna Hewett)

Population genomics and molecular epidemiology of wheat powdery mildew in Europe (Jigisha Jigisha)

A method for identifying spatially divergent selection considering structured populations (Isabela do O)

Revealing the fine-scale genomic structure of a wood ant supercolony (Matthieu de Lamarre)

Decoding Dipteran evolution: comparative mitogenomics insights with a focus on Calliphoridae flies (Drashti Parmar)

The role of genomic introgression and incompatibilities in an asymmetric hybrid zone between two *Formica* species (Sarya Fark)

SESSION 9: SELFISH ELEMENTS & STRATEGIES (Chair Afra Salazar)

ANTHROPÔLE 2024

Selfishness and the evolution of atypical reproductive modes (Luca Soldini)

Evolution of Einkorn wheat centromeres is driven by the mutualistic interplay of two LTR retrotransposons (Matthias Heuberger)

Holocentric genome evolution in sedges (family Cyperaceae) (Ashwini V. Mohan)

Hybridogenesis as an intermediate step between sexual reproduction and parthenogenesis (Alexander Brandt)

The atypical meiosis of the nematode *Mesorhabditis belari* «When biased segregation of chromatids maintains heterozygosity» (Caroline S. Blanc)

Incongruence and structural variation shape rapid mitogenome evolution in a 2000-isolate panel of the major wheat pathogen (Ivan Skakov)

Lunch

12:00 - 13:30

SEE MAP FOR LOCATION

PARALLEL SESSIONS

13:30 - 14:30

SESSION 10: COMMUNITIES & INTERACTIONS (Chair Erica McGale)

ANTHROPÔLE 1031

A competition-detoxification balance controls the evolution of resistance in simple microbial communities
(Massimo Amicone)

Phenotypic and genomic response to limited access to natural pollinator community in *Brassica rapa*
(Elisabeth Authier)

Studying the genetic basis of ecological interactions with intergenomic epistasis
(Loraine Hablützel)

Plant-pollinator networks reveal shifts in evolutionary history across macroecological gradients
(Agostina Torres)

SESSION 11: HOST, PARASITES & PATHOGENS (Chair Clara Castex)

ANTHROPÔLE 1029

Pathogen sharing in plant species: the role of plant traits
(Louisa Neubauer)

Historical sediment reveals a timeseries of antagonistic coevolution in a model host-parasite system
(Jahn Ringger)

The chimeric wheat resistance protein PM4 mediates recognition and phosphorylation of a non-canonical wheat powdery mildew effector
(Zoe Bernasconi)

Migratory birds spread their Haemosporidian parasites along the world's major migratory flyways
(Antoine Perrin)

SESSION 12: OPEN SESSION (Chair Caleb Beck)

ANTHROPÔLE 2024

Testing the fitness effects of chromosomal inversions in threespine sticklebacks
(Juliana Rodriguez-Fuentes)

Altruism and natural selection in a variable environment
(Miguel dos Santos)

Museomics to improve eDNA monitoring of marine fishes
(Sarah Schmid)

Artificial light at night (ALAN) advances reproductive phenology and disrupt circadian rhythm of wild flowers
(Vincent Grognez)

POSTER SESSION B & COFFEE BREAK

14:30 - 15:30

COFFEE IN POSTER AREA, SEE MAP

PLENARY 4

15:30 - 16:30

JOANITO LIBERTI

ANTHROPÔLE 1031

CLOSING CEREMONY

16:30 - 17:15

SCHLÄFLI PRIZE & TALK

Common evolutionary origin of acoustic communication in choanate vertebrates (Gabriel Jorgewich Cohen)

POSTER & TALK PRIZES

BIOLOGY '26 ANNOUNCEMENT

ANTHROPÔLE 1031